



LUMINAIRE TESTING LABORATORY, INC.



SUSTAINING
MEMBER

905 Harrison Street · Allentown, PA 18103 · (610) 770-1044 · Fax (610) 770-8912 · www.LuminaireTesting.com

LTL NUMBER: 05080

DATE: 3-20-2000

PREPARED FOR: VANTAGE LUMINAIRES

CATALOG NUMBER: 7HF218E107600SCL

LUMINAIRE: FORMED STEEL HOUSING, SPUN SEMI-SPECULAR ALUMINUM
REFLECTOR, NO ENCLOSURE.

LAMPS: TWO SYLVANIA CF18DD/E/835 RATED AT 1250 LUMENS EACH.

BALLAST: ONE ADVANCE ICF-2S18-H1-LD

MOUNTING: RECESSED

TOTAL INPUT WATTS = 33.8 AT 120.0 VOLTS

THE 0 DEGREE PLANE IS PARALLEL WITH THE LAMPS.

CANDELA DISTRIBUTION

	0.0	22.5	45.0	67.5	90.0
0	713	713	713	713	713
5	712	727	747	754	761
15	695	744	787	809	781
25	678	753	772	809	857
35	615	638	685	680	691
45	358	386	416	405	405
55	58	64	82	90	93
65	3	4	3	4	4
75	4	3	3	3	3
85	1	1	1	1	0
90	0	0	0	0	0

ZONAL LUMEN SUMMARY

ZONE	LUMENS	%LAMP	%FIXT
0- 30	646	25.8	44.7
0- 40	1058	42.3	73.2
0- 60	1435	57.4	99.3
0- 90	1445	57.8	100.0
90-180	0	0.0	0.0
0-180	1445	57.8	100.0

TOTAL LUMINAIRE EFFICIENCY: 57.8%

CIE TYPE: DIRECT

PLANE: 0-DEG 90-DEG

SPACING CRITERIA: 1.4 1.4

LUMINOUS DIAMETER: 6.500

LUMINANCE IN CANDELA PER SQUARE METER

ANGLE IN DEG	AVERAGE 0-DEG	AVERAGE 45-DEG	AVERAGE 90-DEG
0	33302.	33302.	33302.
45	23647.	27478.	26752.
55	4723.	6677.	7573.
65	332.	332.	442.
75	722.	541.	541.
85	536.	536.	0.

FLUX

71
218
356
413
301
76
6
3
1

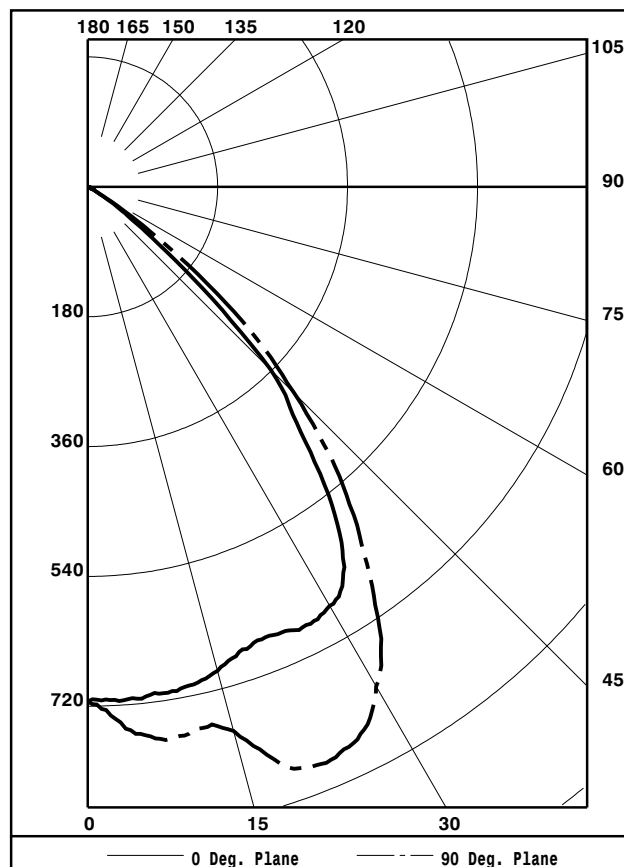
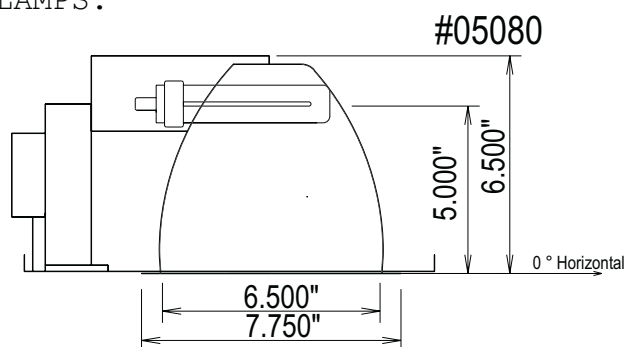

TESTED BY HERSCHEL SCHRECK
CHECKED BY MIKE GRATHER

THIS REPORT BASED ON LM-41 AND OTHER PERTINENT IES PROCEDURES.



LUMINAIRE TESTING LABORATORY, INC.



SUSTAINING
MEMBER

905 Harrison Street · Allentown, PA 18103 · (610) 770-1044 · Fax (610) 770-8912 · www.LuminaireTesting.com

LTL NUMBER: 05080

DATE: 3-20-2000

PREPARED FOR: VANTAGE LUMINAIRES

COEFFICIENTS OF UTILIZATION - ZONAL CAVITY METHOD
EFFECTIVE FLOOR CAVITY REFLECTANCE 0.20

RC	80				70				50			30			10			0
RW	70	50	30	10	70	50	30	10	50	30	10	50	30	10	50	30	10	0
0	69	69	69	69	67	67	67	67	64	64	64	61	61	61	59	59	59	58
1	65	63	62	60	64	62	61	59	60	59	58	58	57	56	56	55	54	53
2	62	58	56	54	60	57	55	53	55	54	52	54	52	51	52	51	50	49
3	58	54	50	48	57	53	50	47	51	49	47	50	48	46	48	47	45	44
4	54	49	46	43	53	49	45	43	47	44	42	46	44	41	45	43	41	40
5	51	45	41	38	50	44	41	38	43	40	38	42	40	37	41	39	37	36
6	47	41	37	35	46	41	37	34	40	37	34	39	36	34	38	36	34	33
7	44	38	34	31	43	37	34	31	37	33	31	36	33	30	35	32	30	29
8	41	34	30	27	40	34	30	27	33	30	27	33	29	27	32	29	27	26
9	38	31	27	24	37	31	27	24	30	26	24	29	26	24	29	26	24	23
10	35	28	24	21	34	28	24	21	27	24	21	27	24	21	26	23	21	20

CANDELA DISTRIBUTION

	0.0	22.5	45.0	67.5	90.0
0	713	713	713	713	713
5	712	727	747	754	761
10	710	747	778	787	772
15	695	744	787	809	781
20	672	748	782	821	858
25	678	753	772	809	857
30	671	696	734	763	800
35	615	638	685	680	691
40	480	576	575	565	558
45	358	386	416	405	405
50	158	189	218	237	248
55	58	64	82	90	93
60	15	15	15	14	15
65	3	4	3	4	4
70	5	5	5	5	5
75	4	3	3	3	3
80	2	2	2	2	2
85	1	1	1	1	0
90	0	0	0	0	0

ZONAL LUMEN SUMMARY

0- 5	17.
5- 10	54.
10- 15	91.
15- 20	127.
20- 25	164.
25- 30	192.
30- 35	206.
35- 40	207.
40- 45	179.
45- 50	122.
50- 55	58.
55- 60	18.
60- 65	4.
65- 70	2.
70- 75	1.
75- 80	1.
80- 85	1.
85- 90	0.

THIS TEST WAS CONDUCTED USING RELATIVE PHOTOMETRY TECHNIQUES ACCORDING TO STANDARD IESNA PROCEDURES. THE USER MUST THEREFORE USE CAUTION IN THE FOLLOWING SITUATIONS: 1) THIS TEST WAS PERFORMED USING A SPECIFIC BALLAST/LAMP COMBINATION. EXTRAPOLATION OF THESE DATA FOR OTHER BALLAST/LAMP COMBINATIONS MAY PRODUCE ERRONEOUS RESULTS. 2) ACCORDING TO IESNA PROCEDURES, THE BALLAST(S) AND LAMP(S) ARE PRESUMED TO PRODUCE 100% OF RATED OUTPUT. AN APPROPRIATE BALLAST FACTOR MUST BE APPLIED TO THE LUMEN OUTPUT RATINGS AND LUMINOUS INTENSITY VALUES GIVEN. 3) THIS TEST WAS CONDUCTED IN A CONTROLLED LABORATORY ENVIRONMENT WHERE THE AMBIENT TEMPERATURE WAS HELD AT 25°C ±1°C. FIELD PERFORMANCE MAY DIFFER PARTICULARLY IN REGARDS TO CHANGE IN LUMINOUS OUTPUT AS A RESULT OF DIFFERENCE IN AMBIENT TEMPERATURE AND METHOD OF MOUNTING THE LUMINAIRE.



LUMINAIRE TESTING LABORATORY, INC.



SUSTAINING
MEMBER

905 Harrison Street · Allentown, PA 18103 · (610) 770-1044 · Fax (610) 770-8912 · www.LuminaireTesting.com

LTL TEST #05080

CIRCLE-OF-LIGHT

Ft below	FC nadir	Dia @ 50%
6.0	19.8	8.5
8.0	11.1	11.3
10.0	7.1	14.2
12.0	5.0	17.0
14.0	3.6	19.8
16.0	2.8	22.7

NOTE: 'Dia' spans the edge-points that are half of nadir FC