



LUMINAIRE TESTING LABORATORY, INC.



SUSTAINING
MEMBER

905 Harrison Street · Allentown, PA 18103 · (610) 770-1044 · Fax (610) 770-8912 · www.LuminaireTesting.com

LTL NUMBER: 05110

DATE: 4-12-2000

PREPARED FOR: VANTAGE LUMINAIRES

CATALOG NUMBER: 8HF2X18E8600SCL

LUMINAIRE: FORMED STEEL HOUSING, SPUN SEMI-SPECULAR ALUMINUM
REFLECTOR, OPEN BOTTOM.

LAMPS: TWO SYLVANIA CF18DD/E/835 RATED AT 1250 LUMENS EACH.

BALLAST: ONE ACE CSD-118PBM

MOUNTING: RECESSED

TOTAL INPUT WATTS = 31.8 AT 120.0 VOLTS

THE 0 DEGREE PLANE IS PARALLEL WITH THE LAMPS.

CANDELA DISTRIBUTION

	0.0	22.5	45.0	67.5	90.0	112.5	135.0	157.5	180.0	FLUX
0	546	546	546	546	546	546	546	546	546	
5	568	595	639	685	697	686	666	644	635	64
15	581	665	769	837	823	885	867	796	722	221
25	546	657	703	736	732	750	759	714	634	327
35	510	575	647	694	714	720	711	645	588	413
45	431	492	567	637	639	636	618	575	536	449
55	214	218	228	224	207	207	187	178	182	190
65	7	8	7	7	8	7	8	7	7	6
75	6	6	5	6	4	6	6	5	6	6
85	0	0	0	0	0	0	0	0	0	1
90	0	0	0	0	0	0	0	0	0	

ZONAL LUMEN SUMMARY

ZONE	LUMENS	%LAMP	%FIXT
0- 30	612	24.5	36.5
0- 40	1025	41.0	61.2
0- 60	1664	66.6	99.3
0- 90	1676	67.0	100.0
90-180	0	0.0	0.0
0-180	1676	67.0	100.0

TOTAL LUMINAIRE EFFICIENCY:

67.0%

CIE TYPE: DIRECT

LUMINOUS DIAMETER: 7.500

LUMINANCE IN CANDELA PER SQUARE METER

ANGLE IN DEG	AVERAGE 0-DEG	AVERAGE 45-DEG	AVERAGE 90-DEG
0	19155.	19155.	19155.
45	21384.	28131.	31703.
55	13089.	13945.	12661.
65	581.	581.	664.
75	813.	678.	542.
85	0.	0.	0.

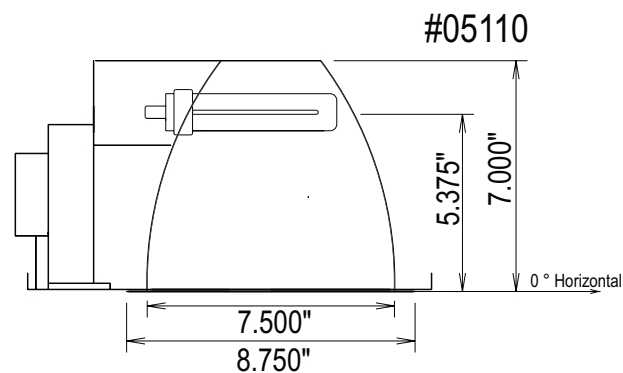

TESTED BY HERSCHEL SCHRECK
CHECKED BY MIKE GRATHER

THIS REPORT BASED ON LM-41 AND OTHER PERTINENT IES PROCEDURES.



LUMINAIRE TESTING LABORATORY, INC.



SUSTAINING
MEMBER

905 Harrison Street · Allentown, PA 18103 · (610) 770-1044 · Fax (610) 770-8912 · www.LuminaireTesting.com

LTL NUMBER: 05110

DATE: 4-12-2000

PREPARED FOR: VANTAGE LUMINAIRES

CANDELA DISTRIBUTION

	0.0	22.5	45.0	67.5	90.0	112.5	135.0	157.5	180.0
0	546	546	546	546	546	546	546	546	546
5	568	595	639	685	697	686	666	644	635
10	588	634	709	772	792	805	777	716	688
15	581	665	769	837	823	885	867	796	722
20	591	674	755	807	823	845	843	794	745
25	546	657	703	736	732	750	759	714	634
30	492	614	682	716	706	731	722	668	570
35	510	575	647	694	714	720	711	645	588
40	496	567	633	677	681	697	699	643	580
45	431	492	567	637	639	636	618	575	536
50	394	425	460	517	521	521	503	475	486
55	214	218	228	224	207	207	187	178	182
60	15	16	14	13	12	11	11	11	11
65	7	8	7	7	8	7	8	7	7
70	7	7	7	7	7	7	7	7	7
75	6	6	5	6	4	6	6	5	6
80	4	3	3	2	2	2	3	3	3
85	0	0	0	0	0	0	0	0	0
90	0	0	0	0	0	0	0	0	0

ZONAL LUMEN SUMMARY

0- 5	14.
5- 10	50.
10- 15	90.
15- 20	132.
20- 25	154.
25- 30	173.
30- 35	195.
35- 40	218.
40- 45	230.
45- 50	219.
50- 55	165.
55- 60	25.
60- 65	3.
65- 70	3.
70- 75	3.
75- 80	2.
80- 85	1.
85- 90	0.

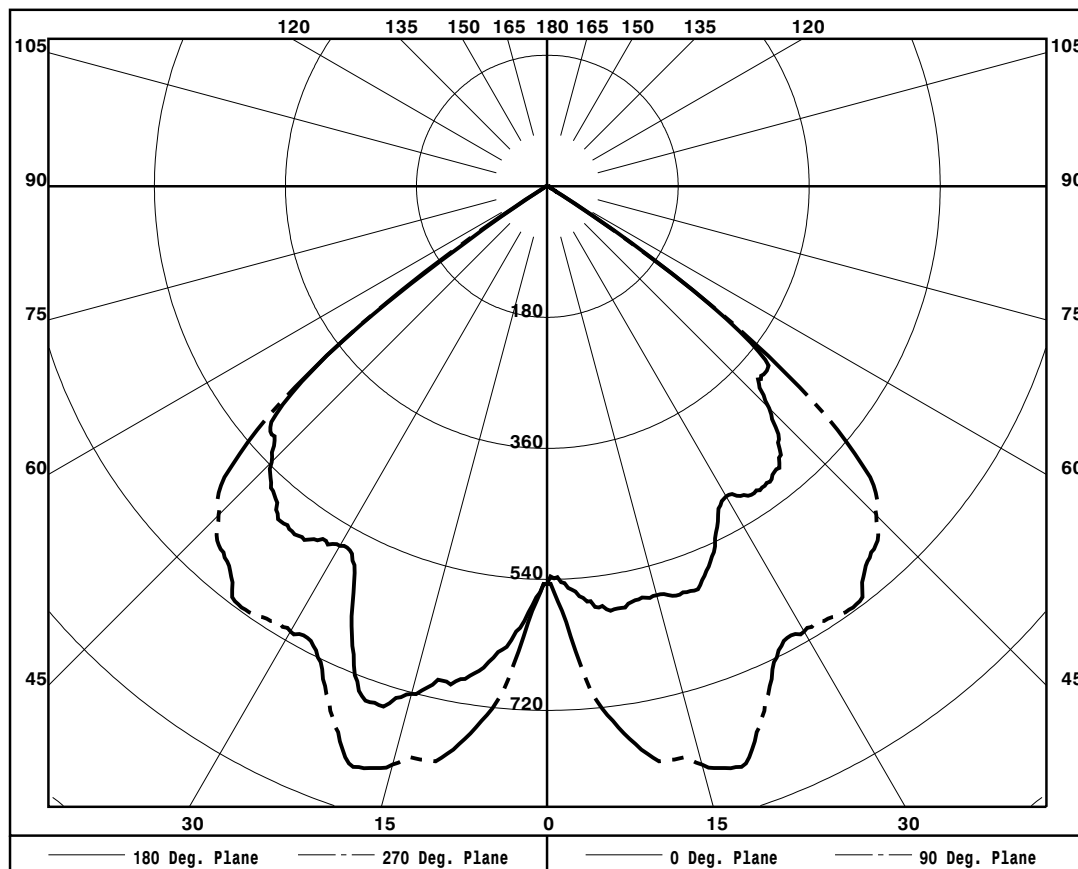



LUMINAIRE TESTING LABORATORY, INC.



SUSTAINING
MEMBER

905 Harrison Street · Allentown, PA 18103 · (610) 770-1044 · Fax (610) 770-8912 · www.LuminaireTesting.com

LTL NUMBER: 05110

DATE: 4-12-2000

PREPARED FOR: VANTAGE LUMINAIRES

COEFFICIENTS OF UTILIZATION - ZONAL CAVITY METHOD

EFFECTIVE FLOOR CAVITY REFLECTANCE 0.20

RC	80				70				50			30			10			0
RW	70	50	30	10	70	50	30	10	50	30	10	50	30	10	50	30	10	0
0	80	80	80	80	78	78	78	78	75	75	75	71	71	71	68	68	68	67
1	75	73	71	69	74	72	70	68	69	67	66	66	65	64	64	63	62	61
2	71	67	64	61	69	66	63	60	63	61	59	61	59	58	59	58	56	55
3	66	61	57	54	65	60	56	53	58	55	52	56	54	51	55	53	51	49
4	62	55	51	47	60	54	50	47	53	49	46	52	48	46	50	48	45	44
5	57	50	45	42	56	49	45	41	48	44	41	47	43	41	46	43	40	39
6	53	45	40	37	52	45	40	37	44	40	36	43	39	36	42	38	36	35
7	49	41	36	32	48	41	36	32	40	35	32	39	35	32	38	34	32	30
8	45	37	32	28	44	36	31	28	35	31	28	35	31	28	34	30	28	26
9	41	33	28	24	40	32	28	24	32	27	24	31	27	24	30	27	24	23
10	38	30	25	21	37	29	25	21	29	24	21	28	24	21	27	24	21	20

NOTE: THE ZONAL CAVITY CALCULATION TECHNIQUE IS ACCURATE WHEN LUMINAIRES WITH SYMMETRIC CANDELA DISTRIBUTIONS ARE EMPLOYED AND WHEN THE LUMINAIRES ARE LOCATED SYMMETRICALLY THROUGHOUT THE ROOM. THIS UNIT HAS SPECIAL CHARACTERISTICS AND THEREFORE THESE COEFFICIENTS SHOULD BE USED WITH CAUTION.

THIS TEST WAS CONDUCTED USING RELATIVE PHOTOMETRY TECHNIQUES ACCORDING TO STANDARD IESNA PROCEDURES. THE USER MUST THEREFORE USE CAUTION IN THE FOLLOWING SITUATIONS: 1) THIS TEST WAS PERFORMED USING A SPECIFIC BALLAST/LAMP COMBINATION. EXTRAPOLATION OF THESE DATA FOR OTHER BALLAST/LAMP COMBINATIONS MAY PRODUCE ERRONEOUS RESULTS. 2) ACCORDING TO IESNA PROCEDURES, THE BALLAST(S) AND LAMP(S) ARE PRESUMED TO PRODUCE 100% OF RATED OUTPUT. AN APPROPRIATE BALLAST FACTOR MUST BE APPLIED TO THE LUMEN OUTPUT RATINGS AND LUMINOUS INTENSITY VALUES GIVEN. 3) THIS TEST WAS CONDUCTED IN A CONTROLLED LABORATORY ENVIRONMENT WHERE THE AMBIENT TEMPERATURE WAS HELD AT 25°C ±1°C. FIELD PERFORMANCE MAY DIFFER PARTICULARLY IN REGARDS TO CHANGE IN LUMINOUS OUTPUT AS A RESULT OF DIFFERENCE IN AMBIENT TEMPERATURE AND METHOD OF MOUNTING THE LUMINAIRE.